

CLAM - CLM

Pomello a 3 Lobi con Perno Filettato

3 Lobe Knob with Threaded Stud

Codice Arancio Orange Code	Codice Nero Black Code	D	H	d1	d	e	h2	U.V.
CLAM250415	CLM250415	25	17	12	04MA	15	6	10
CLAM250620	CLM250620	25	17	12	06MA	20	6	10
CLAM320520	CLM320520	32	20	14	05MA	20	6	10
CLAM320620	CLM320620	32	20	14	06MA	20	6	10
CLAM320827	CLM320827	32	20	14	08MA	27	6	10
CLAM320840	CLM320840	32	20	14	08MA	40	6	10
CLAM400815	CLM400815	40	25	17	08MA	15	7	10
CLAM400833	CLM400833	40	25	17	08MA	33	7	10
CLAM401044	CLM401044	40	25	17	10MA	44	7	10
CLAM501033	CLM501033	50	32	19	10MA	33	8	10
CLAM501050	CLM501050	50	32	19	10MA	50	8	10
CLAM501240	CLM501240	50	32	19	12MA	40	8	10
CLAM631033	CLM631033	63	40	23	10MA	33	11	10
CLAM631240	CLM631240	63	40	23	12MA	40	11	10

Caratteristiche

Materiale Corpo:

Poliammide rinforzata fibra di vetro

Parte Metallica:

Vite filettata in acciaio zincato

Colori:



Su richiesta:



Product specification

Main Part Material:

Reinforced polyamide

Metallic Part Material:

Zinc plated threaded stud

Colours:



On Request:



CLAM



CLM

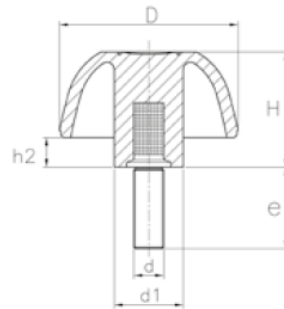

CLAB - CLB

Pomello a 3 Lobi con Boccola Filettata Cieca

3 Lobe Knob with Threaded Blind Insert

COD. Arancio Orange Code	COD. Nero Black Code	D	H	d1	d	e	h2	U.V.
CLAB2504	CLB2504	25	17	12	04MA	8,5	6	10
CLAB3205	CLB3205	32	20	14	05MA	9	6	10
CLAB3206	CLB3206	32	20	14	06MA	10	6	10
CLAB4008	CLB4008	40	25	17	08MA	14	7	10
CLAB4010	CLB4010	40	25	17	10MA	17	7	10
CLAB5008	CLB5008	50	32	19	08MA	14	8	10
CLAB5010	CLB5010	50	32	19	10MA	17	8	10
CLAB5012	CLB5012	50	32	19	12MA	19	8	10
CLAB6310	CLB6310	63	40	23	10MA	17	11	10
CLAB6312	CLB6312	63	40	23	12MA	19	11	10
CLAB6316	CLB6316	63	40	23	16MA	27	11	10

Caratteristiche

Materiale Corpo:

Poliammide rinforzata fibra di vetro

Parte Metallica: Boccola in ottone filettata

Colori:



Su richiesta:



Product specification

Main Part Material: Reinforced polyamide

Metallic Part Material:

Threaded brass insert

Colours:



On Request:



CLB



CLAB

